

## Service Center Design

When designing a service center, several things need to be kept in mind.

1. Always take safety into account. When working with agricultural power, we find ourselves in an environment of heavy equipment, flammable material and moving parts.
2. Take a look at several designs and shop layouts before you devote to an idea. Remember, many people have built service centers afterwards wishing they could add or modify some aspect.
3. Service centers need to be accessible for large equipment. You seldom hear a shop owner claiming their facility is too big. Most often, available funding drives the size of a service center.

### Things to Consider

- Tall overhead doors
- Wash bay
- Outside fuel and oil storage
- Floor lift
- An office with phone and personal computer
- Ventilation system
- Skylights
- High intensity lighting system
- Manifold air system

### General Tools List

- |                        |                    |                      |
|------------------------|--------------------|----------------------|
| Air compressor         | Hoist              | Slip-joint pliers    |
| Air impact wrench      | Jack               | Spark-plug tester    |
| Allen wrenches         | Lamb               | Speed indicators     |
| Battery charger        | Micrometers        | Stands               |
| Bender                 | Metric socket sets | Standard socket sets |
| Bolt cutters           | Metric wrench sets | Standard wrench sets |
| Brake bleeder          | Needle-nose pliers | Testers              |
| Chain                  | Parts cleaner      | Thickness gauges     |
| Creeper                | Pressure washer    | Timing light         |
| Distributor wrench set | Pullers            |                      |
| Drill                  | Saw                |                      |
| Grinder                | Shears             |                      |

Below is a simple service center designed by a student.

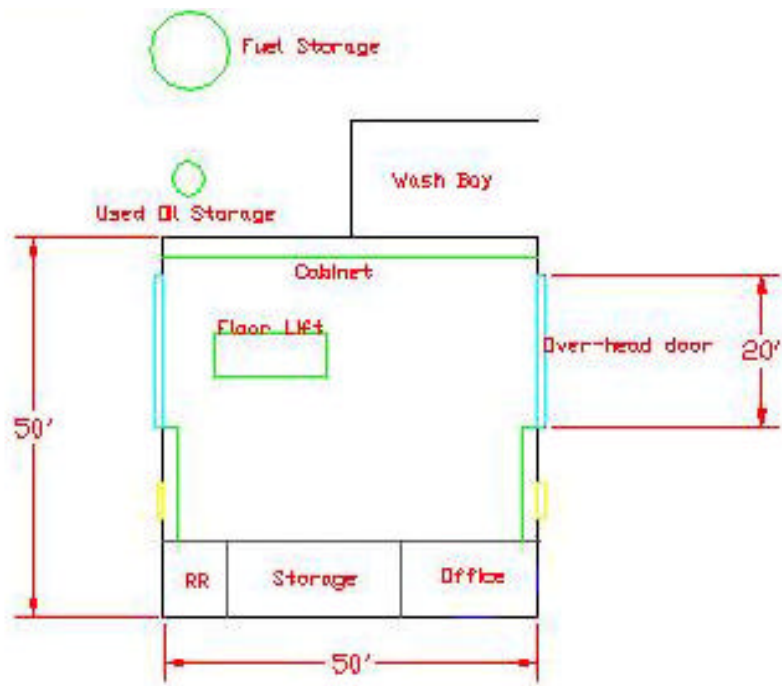

### Activity

- Design and sketch an agricultural power service center that will best suit your local needs.
- Dimension the facility to any size.
- Provide a detailed list of tools for your shop.